

MITHOS³ PLUS 14

PELLET AIR PLUS - Pellet stoves

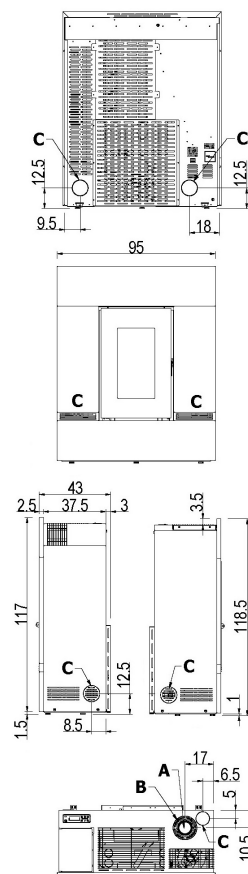

Nominal power	kW	14
Reduced power	kW	3,8
Introduced thermal power (max)	kW	15,7
Nominal water useful power	kW	-
Reduced water useful power	kW	-
Nominal efficiency	%	89
Reduced efficiency	%	93,5
Heating volume (min-max)	m ³	91 - 336
Nominal CO at 13% O ₂	%	0,0197
Reduced CO at 13% O ₂	%	0,0149
Emissions CO (13% O ₂) (min-max)	mg/Nm ³	186 - 247
Emissions OGC (13% O ₂) (min-max)	mg/Nm ³	3,0 - 3,0
Emissions NOX (13% O ₂) (min-max)	mg/Nm ³	109 - 114
Dust content at 13% O ₂ (min-max)	mg/Nm ³	19 - 15
Boiler capacity (H ₂ O)	l	-
Hopper capacity	kg	23
Combustible		Pellet ø6
Hourly consumption (min-max)	kg/h	0,86 - 3,5
Autonomy (min-max)	h	7 - 27
Ignition electrical absorption (max)	W	360
Operating electrical absorption (max)	W	153
Supply and frequency	V - Hz	230 - 50
Chimney flue depression	Pa	13
Exhaust diameter	mm	80
Combustion air inlet diameter	mm	60
Mass of smoke (min-max)	g/sec	3,9 - 9,2
Exhaust fumes temperature (max)	°C	210
Net weight	kg	165
Gross weight	kg	180
Exhaust fumes	see	A
Hole combustion air inlet	see	B
Ducting outlet	see	C
Ducting capability up to	m	8



MATCH

7021035	NEUTRAL STRUCTURE	EAN 8053859013518
6921027	White steel	EAN 8053859014102
6921028	Red steel	EAN 8053859014119
6921029	Anthracite steel	EAN 8053859014126
6921030	Steel light bronze	EAN 8053859014133
6921031	Steel titanium	EAN 8053859014140

PLUS

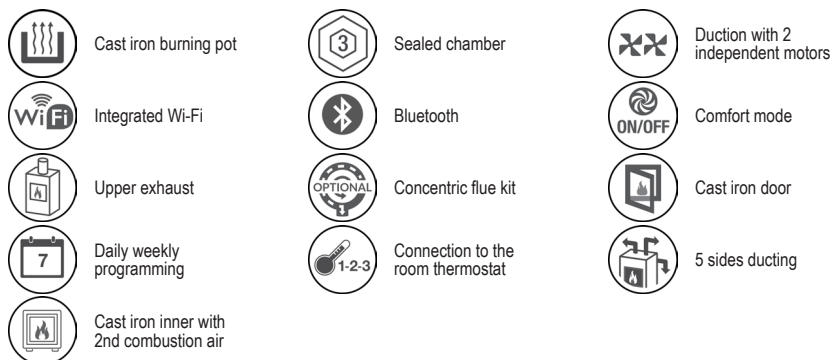

STOVE PACKING

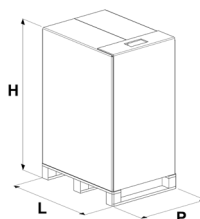

L (cm)	H (cm)	P (cm)
80	132,3	102

VOLUME (m ³)
1,0

LINING PACKING

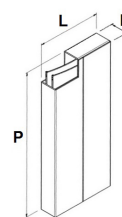

L (cm)	H (cm)	P (cm)	
steel	59	12,5	109,2

STOCKING

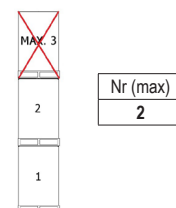

TRANSPORT

